

## The Garden

The City of San Jacinto's new water-wise garden has been designed with water conservation in mind. The purpose of this garden is to educate our community about the beauty and water saving benefits of planting drought tolerant and native California plants. The garden was designed primarily with California native plants. However, there are also plants from around the world that thrive in Southern California. Plants from Mexico, South America, the American Southwest, the Mediterranean, South Africa and Australia. Due to the historical nature of the park, we thought it important to identify the origins of the plants. The garden is roughly divided into climate regions; Desert, Inland Chaparral, Coastal and Mediterranean or Southern Californian. These divisions are not strict and plants are aesthetically mixed throughout the Garden. But plants are grouped by similar water needs. Each of these areas are irrigated differently in order to show that there are many different ways to irrigate which are "Water Wise".



### Coastal Planting



This area is anchored by plants from Catalina Island, Baja California and the Coasts of North and South California, but includes only those plants that can withstand the increased heat and cold of the San Jacinto Valley. When you are selecting plants for your landscape, always note their frost and heat



### Inland Chaparral Planting

Chaparral is a California plant community that occurs in foothills from the coasts to the Sierra Nevada and all the mountain ranges of Southern California. These plants are well adapted to the San Jacinto Valley and will create a true native look to your garden.



### Inland Chaparral Area

### Mediterranean Planting

This area has the greatest mixture of plant origins. 'Ornamental Southern California' would be another title for this area. Australia, Mediterranean Region, South Africa and South American plants have been used in Southern California for decades. 'Water-Wise' plants do not require the fertilization that standard ornamentals do. Over fertilization of drought tolerant plants will speed their growth but often shorten their life span.



### Mediterranean Area

### Desert Planting

This sparsely planted area reflects natural terrain plants from California High Deserts (Victor Valley), Low Deserts (Coachella Valley), as well as Baja California, Arizona, Texas and others. The lowest water use plants from other regions are also included here. Low water use plants can not usually withstand conventional spray irrigation or overhead watering of any kind.



### Desert Area



# Estudillo Heritage Park Water Conservation Education Garden

**"KEEP IT WATER-WISE,  
KEEP IT BEAUTIFUL"**  
A Rich History, A Bright Future

A cooperative effort of the  
City of San Jacinto Redevelopment Agency,  
Eastern Municipal Water District and  
Metropolitan Water District of Southern California



City of San Jacinto Museum  
695 Ash Street—San Jacinto, CA 92583  
Phone: 951-654-4952 Call For Hours  
[www.ci.san-jacinto.ca.us](http://www.ci.san-jacinto.ca.us)

### NOTES:



### Coastal Area

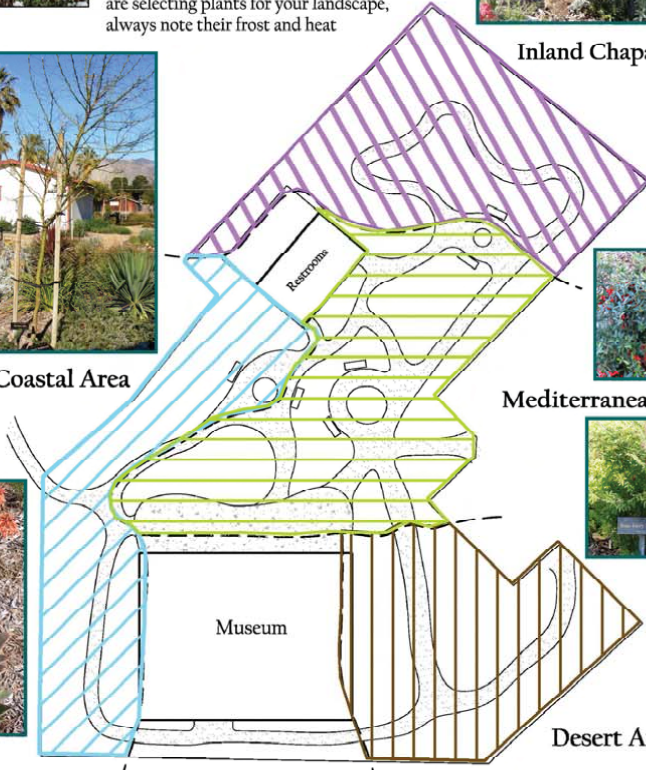

## SHRUB

'AC' Sage  
Australian Dracaena  
Baja Fairy Duster  
Black Sage  
Bottle Brush  
Blue Oat Grass  
Bush Morning Glory  
Bush Sunflower  
California Encelia  
California Fuschia  
California Laurel  
California Sage Brush  
Canyon Prince Giant Wild Rye  
Centennial Coyote Brush  
Century Plant  
Century Plant, Variegated  
Chuparosa  
Cleveland Sage  
Coast Silk Tassel  
Coral Aloe  
Coreopsis 'Early Sunrise'  
Cotoneaster buxifolius  
Cream Fortnight Lily  
Desert Agave  
Desert Spoon  
Dusty Miller  
Dwarf Bottlebrush  
Dwarf Poinciana  
English Lavender  
Fairy Duster  
Feather Reed Grass  
Feathery Cassia  
Firethorn  
Flannel Bush  
Flax  
Flowering Pine  
Foxtail Agave  
Fuchsia Flowering Gooseberry  
Giant Coreopsis



Ground Morning Glory  
Hardy Yellow Trumpet Flower  
Indian Fig  
Island Bush Snapdragon  
Jojoba

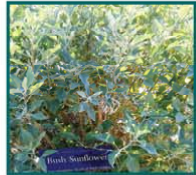

Kangaroo Paw  
Lemonade Berry  
Lilac  
Lion's Tail  
Lord's Candle



Low Germander  
Medicinal Aloe  
Mexican Grass Tree  
Nolina  
Ocotillo



Octopus Agave  
Orchid Rockrose  
Oregon Grape  
Organ Pipe Cactus  
Ponytail Palm



Powis Castle Wormwood  
Prostrate Rosemary  
Purple Hopseed Bush  
Purple Sage  
Red Fountain Grass  
Red Yucca



Sageleaf Rockrose  
Salt Bush  
Scarlet Bugler  
Showy Penstemon  
Southern Yucca  
Sugar Bush  
Swordfern  
Texas Sage  
Torch Lily  
Tree Mallow  
Western Lilac  
Wild Rose  
Yellow Oleander



## GROUND COVER

Bearberry  
Blanketflower  
Blue-eyed Grass  
California Buckwheat  
California Currant  
Coyote Brush  
Creeping Mahonia  
Deer Grass  
Low BearBerry  
Matilija Poppy  
Mauve Clusters  
Mexican Primrose  
Monkey Flower  
Myoporum  
Poverty Weed  
Stone Crop  
Sun Rose  
Trailing Indigo Bush  
Yarrow  
Yellow Gold Lantana



## Plant Resources

Nurseries that grow drought tolerant, low water, plant material used at the City of San Jacinto Estudillo Heritage Park Water Conservation Garden include the following:

B&B Nurserytown, 25260 Sultanas Rd, Homeland 951.926.1134  
California Cactus Center, Pasadena 626.795.2788 [www.cactuscenter.com](http://www.cactuscenter.com)  
El Nativo, Azusa 626.969.8449 [www.elnativogrowers.com](http://www.elnativogrowers.com)  
GroWest Nurseries, 1700 Growest Ave, Riverside 951.780.1552  
Mockingbird Nurseries, Riverside 951.780.3571 [www.mockingbirdnursery.com](http://www.mockingbirdnursery.com)  
Tree of Life, San Juan Capistrano 949.728.0685 [www.californianativeplants.com](http://www.californianativeplants.com)  
Village Nurseries, Asst Locations 800.542.0209 [www.villagenurseries.com](http://www.villagenurseries.com)

## Non-Profit Nurseries / Resources

UC Riverside Botanic Gardens 951.784.6962 <http://gardens.ucr.edu>  
The Living Desert Palo Verde Garden Center, Palm Desert 760.346.5694  
<http://www.livingdesert.org>  
The Theodore Payne Foundation, 10459 Tuxford St, Sun Valley 818.768.1802  
<http://www.theodorepayne.org>

